



Sport Brake Lever Part Number BRC553 or BRF353

Congratulations on your purchase of an ASV Sport Street bike lever! ASV Inventions recommends that this lever be installed by a certified mechanic. ASV Inventions, Inc. accepts no liability for malfunctions because of improper installation. Please use the chart below to confirm your year make and model before attempting installation. If the correct year, make and model of your motorcycle is not listed below, please contact ASV inventions for guidance.:

This ASV Sport front brake lever will only fit the following motorcycles.

YAMAHA	YEAR
MT10	2022+
YZF-R7	2022+

For any questions regarding correct application for your motorcycle, please call ASV Inventions, Inc. 1-714-861-1400

INSTALLATION INSTRUCTIONS

1 Remove the main pivot bolt that holds the lever (img 1). After the pivot bolt is removed, the lever will detach from the master cylinder.



See other side for further instructions

INSTALLATION INSTRUCTIONS (continued from other side)

2 Remove the stock plunger rod from the OEM master cylinder and replace with the supplied ASV plunger rod.

3 Carefully place the lever into the master cylinder while lining up the plunger rod into the plunger barrel as shown.

4 Insert the main pivot bolt and tighten it until it is snug against the master cylinder. On the underside, screw the locknut onto the main pivot bolt. Do not over tighten as it can cause binding of the lever and master cylinder. Maximum torque on locknut should be five (5) foot-lbs. or sixty (60) inch-lbs.

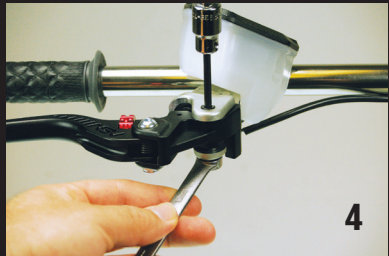
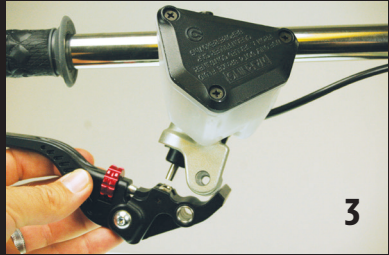

AFTER INSTALLATION with the engine off and bike out of gear, apply the front brake several times to confirm it is functioning properly. You should hear the “clicking” sound of the brake light switch being activated each time you pull the brake lever in. There should be no drag and the front wheel should spin freely when brake is not engaged. With the Key in the “ON” position, your rear brake light

should light up when the front brake is applied, and turn off when the brake lever is released. If something does not seem right, consult your mechanic or contact ASV technical support before riding your motorcycle.

IMPORTANT: Do not ride your motorcycle if there is any drag or the front wheel does not spin freely after installation.



ASV Inventions, Inc

17811 Georgetown Lane, Huntington Beach, CA 92647

714-861-1400 • asvinventions.com