



## CRC575 / CRF375

Hydraulic Clutch Installation Guide v.240905



This lever is designed to replace the stock hydraulic clutch lever on the following motorcycles. Please confirm before installing.

BMW	YEAR
R Nine T	16-24

### INCLUDES

1x ASV Clutch Lever

### TOOLS NEEDED:

1x 10mm wrench  
1x Flathead screwdriver

### USES OEM PARTS

This lever uses parts from the stock lever. If you do not have the stock lever, reach out to ASV for parts info.

**WARNING!** ASV Inventions highly recommends that this lever be installed by a qualified and skilled individual. ASV Inventions INC. accepts no liability for failures or malfunctions due to improper installation. Install at your own risk.

## 1: UNINSTALL THE STOCK CLUTCH LEVER

1a) Remove the 10mm nut and the flathead pivot bolt from the master cylinder. Keep these parts for the ASV lever.



1b) Carefully remove the lever, the stock plunger barrel will fall out. Keep this part for the ASV lever.

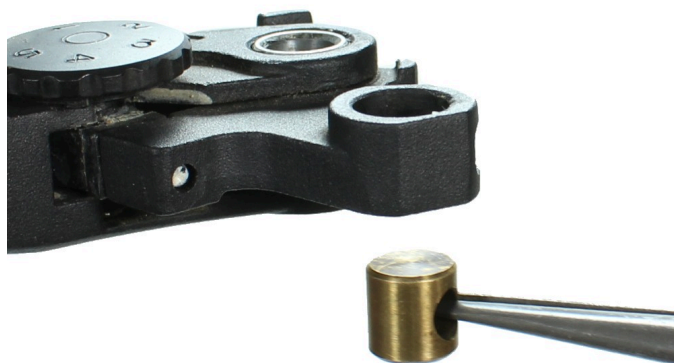

## 2: INSTALL THE PLUNGER BARREL

2a) Insert the stock plunger barrel into the ASV lever.



### 3: INSTALL THE ASV CLUTCH LEVER

3a) Line up the plunger barrel with the plunger rod from the master cylinder and insert the lever into the master cylinder.



3b) Secure the lever with the stock flathead pivot bolt and 10mm nut. Tighten enough to secure the lever. No more than 5lbs of torque.



### 4: ADJUSTING THE CLUTCH LEVER REACH

Use the reach adjust dials to set the levers to your desired reach. ASV levers have much greater reach adjust than stock and can cause issues if they are adjusted too closely to the handlebar. Be sure to test your settings at slow speeds before riding normally.

### 5: TESTING THE NEUTRAL SWITCH

5a) Get into riding position. Place the bike in neutral and attempt to start the bike WITHOUT pulling the clutch lever. The bike should not start.

5b) While still in riding position, pull the lever and attempt to start the bike. This time, the bike should start normally. If it does not, adjust the clutch lever outwards and try again.

If the lever needs to be adjusted extremely far out in order to function, please refer to the troubleshooting guide below.

### 6: TESTING THE CLUTCH

Fully engage the clutch and shift to first gear. Keep the clutch fully engaged. The bike should remain still.

If the bike starts to move forward; turn off the bike, adjust the clutch lever outwards, and try again.

If the lever needs to be adjusted extremely far out in order to function, please refer to the troubleshooting guide below.

**Congratulations!** You have successfully installed the ASV clutch lever on your bike! If you have any questions, please reach out to us at our contact info below.

### OPTIONAL PERCH RISER INSTALL



If you would like to adjust your levers to be closer than stock, you will need an ASV perch riser to raise your perch about half inch over your controls. Contact ASV for more info.



### SUPPORT & TROUBLESHOOTING

#### ASV lever does not fit into the master cylinder.

- Check that the master cylinder on your bike is the same as OEM. On older bikes, it may have been modified or changed.
- Check that the correct pivot bolt is being used. The clutch or brake pivot bolt may have been switched during installation.
- On the ASV lever, check that the bushing inside the pivot opening is properly seated inside the lever.
- Check that the tabs are properly installed on the ASV lever.
- If the ASV clutch lever came with an ASV brake lever, check that you are installing the ASV clutch lever.

#### Bike does not start while the ASV clutch lever is pulled.

- Check that the lever is not adjusted too close to the handlebars.
- Check that the correct tabs were installed on the ASV lever
- Check that the neutral switch button on the master cylinder is being fully released when the ASV lever is pulled.
- (CR50 only) Check that neutral switch button on the master cylinder is being fully pressed by the rod on the ASV lever.

#### Clutch does not engage while the ASV clutch lever is pulled.

- Check that the lever is not adjusted too close to the handlebars.
- Check that the push rod is properly installed. (step 2)
- Reinstall the original lever and see if the issue persists. If so, there may be an issue with the motorcycle's clutch system.

#### Clutch is engaged while the ASV clutch lever is not pulled

- Check that the plunger barrel in the ASV lever and the plunger rod in the master cylinder are properly lined up.
- Check that the plunger barrel is clean

#### ASV clutch lever touches the control switches when pulled

- Check that the lever is not adjusted too close to the handlebars
- The master cylinder may have shifted during installation. Loosen the master cylinder mounting bolts and adjust until it fits.

#### **ASV clutch lever needs to be adjusted extremely far out to work**

- Lever may need a spacer. Spacers are available for free at [asvinventions.com](http://asvinventions.com)

#### **ASV lever does not return after being pulled.**

- Loosen the pivot bolt. It may have been overtightened.

#### **ASV lever touches handguards (dual-sport / adv only)**

- Remove the handguards. In some case, the ASV lever double pivot design is not compatible with factory handguards. If the ASV lever contacts the handguards while riding, it may cause brakes to lockup.
- If the handguard contact is due to the protruding nuts and bolts on the ASV lever, contact ASV for low-profile pins.

#### **Lever has a lot of free play or feels loose**

- Check that the pivot bolt and the nut is securely tightened.
- Check that the correct push rod is properly installed.

Reinstall the original lever and take note of how much free play it has. The ASV lever should have the same amount of free play.

For more troubleshooting options and detailed install videos, visit [www.asvinventions.com/installation/](http://www.asvinventions.com/installation/)

#### **Need help? Send us pics!**

Our techs are available Monday through Friday, 9am to 5pm PST. Please provide as many photos or video of the issue so that we can offer the best assistance.

Phone: **714.861.1400** Email: [info@asvinventions.com](mailto:info@asvinventions.com)

Register your warranty at [www.asvinventions.com/support](http://www.asvinventions.com/support)

**ASV INVENTIONS INC**  
[www.asvinventions.com](http://www.asvinventions.com)

**17811 Georgetown Ln**  
**Huntington Beach, CA92683**  
**Est. 2001**