



Unbreakable Levers Install Guide CRC574 or CRF374

Install at your own risk. ASV Inventions INC. accepts no liability for failures or malfunctions due to improper installation. If you do not feel confident in your ability to install this product, please contact a licensed motorcycle mechanic or ASV Inventions for assistance.

Please use the chart below to confirm your vehicle year, make, and model before attempting installation.

BMW	YEAR
K1600GT / GTL w/stock adjustable lever	15-16
K1600B / Grand Am	17-23
R1200 GS / R / RS	12-18
R1200 RT w/stock adjustable lever	12-14
R1200 RT	15-18
R1250 GS / R / RS / RT	18-23
R nineT	14-16

Tools needed:

1. 2mm hex key wrench
2. T25 Torx wrench
3. 10mm wrench
4. Flathead screwdriver

Part 1: Uninstall mirror

Use your hands to unscrew the mirror COUNTERCLOCKWISE

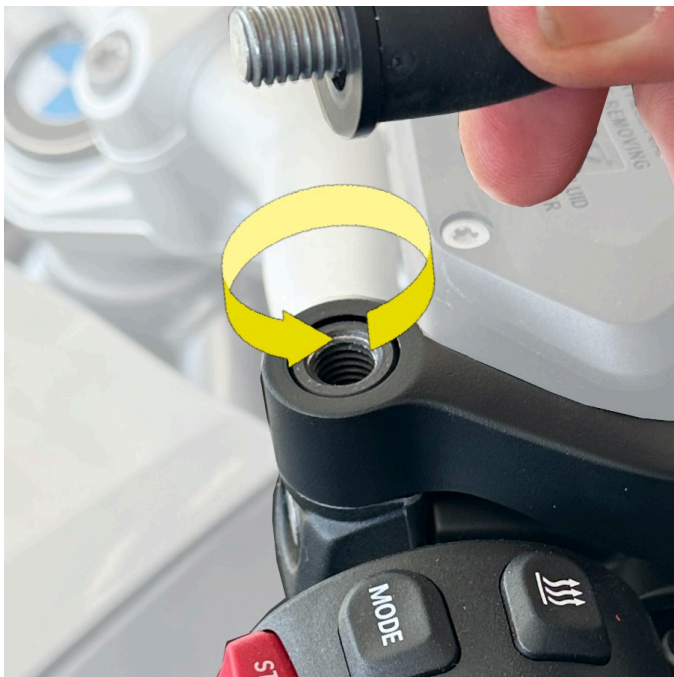

Part 2: Uninstall handguards

2a) Use the T25 Torx wrench to unscrew the small bolt on the handguard and swivel the handguard away from the lever access.



Part 3: Uninstall the OEM lever

3a) Use the T25 Torx wrench and the 10mm wrench to unscrew the nut underneath the main pivot bolt that holds the lever inside the master cylinder.

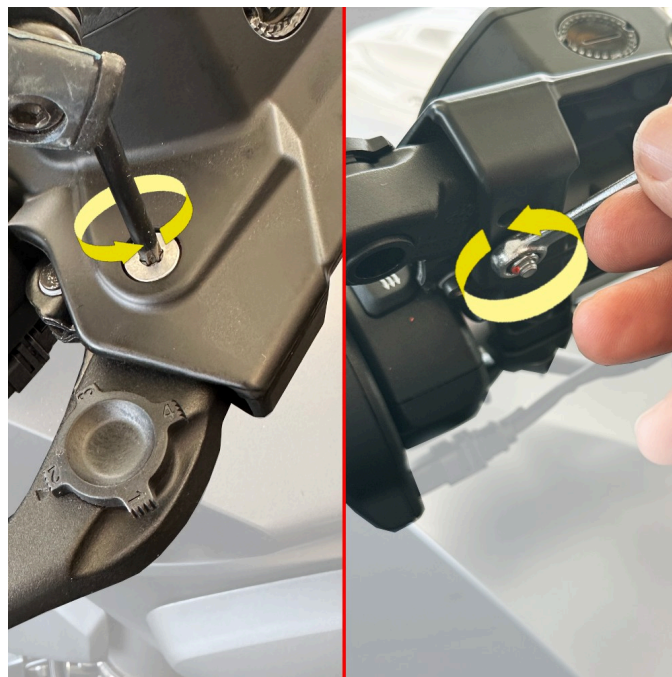

3b) Once the nut is off, use your fingers or a flathead screwdriver to push or pull the Torx bolt out of the master cylinder. Carefully remove the lever from the master cylinder.

3c) On the underside of the lever, use the 2mm hex key wrench to slightly loosen the retaining screw on the push rod barrel. Do not loosen all the way as the retaining screw can be easily lost.

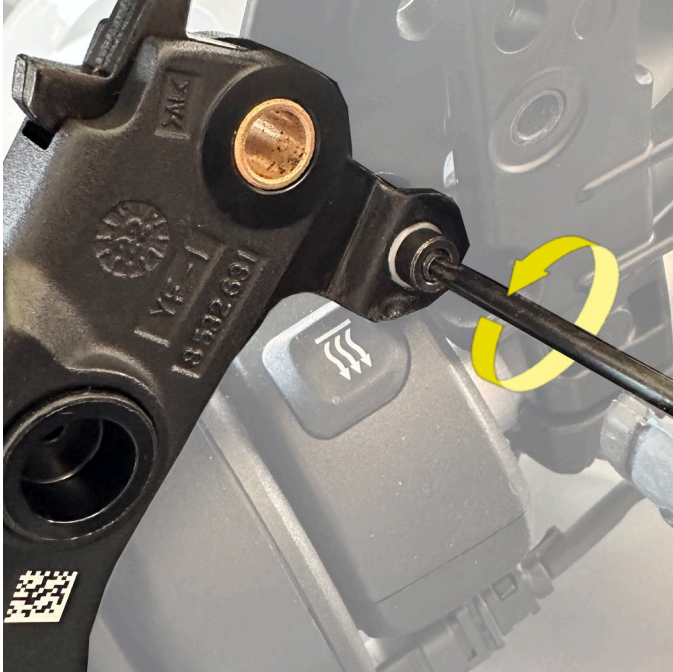

3d) On the inside of the lever, use a 2mm hex key on the push rod screw and turn CLOCKWISE until the lever is released.



3e) Once released, remove the barrel-shaped retainer.

Part 4: Install the ASV lever

4a) Insert the barrel-shaped retainer into the ASV lever.

4b) Use the 2mm hex key wrench and turn COUNTERCLOCKWISE to fasten the push rod to the ASV lever. Keep turning until the push rod sits flush with ends of the ASV lever barrel posts.



4c) Use the 2mm hex key wrench to tighten the push rod retainer screw until the colored threads are no longer visible or flush.

4d) Align the ASV lever into the master cylinder and insert the Torx bolt.

4e) Using a T25 Torx wrench and a 10mm wrench, tighten the nut onto the Torx bolt.

Part 5: Testing / Adjusting your ASV lever

5a) Place your bike in first gear. Pull the clutch lever several times while rocking the bike to make sure the clutch is engaging. Place your bike back in neutral before during the bike on.

5b) Use the reach adjust dials on the ASV levers to set the levers to your desired reach. Adjusting reach will greatly affect brake and clutch engagement. Be sure to test at slow speeds before riding normally.

Congratulations! You have successfully installed the ASV clutch lever on your bike! Enjoy some awesome riding with your new performance controls. If you have any questions, please reach out to us at our contact info below.

ASV INVENTIONS, INC

714.861.1400

info@asvinventions.com

Monday-Friday
9am to 5pm PST

ASV Inventions INC
17811 Georgetown Ln
Huntington Beach, CA 92647

[Don't forget to register for your ASV warranty!](#)